



Coolant Nozzles & CNC Machine Accesories



PH: 503.623.8094



www.winittool.com

About Winit Tool...

Winit Tool a manufacturer of Coolant Nozzles, Workholding Devices and related products for use on CNC Lathes, Machining Centers, Grinders, Screw Machines, Manual Mills and assorted production equipment.

Winit Tool is continually listening to and working with customers to find solutions to their manufacturing problems.

Table of Contents

Coolant Nozzles

1-6

Eco-Jet
Flush-Jet
Monkey Knuckles
Thread Jet
Screw Lock
Copper Coolant Products

Workholding

6-10

Bed Clamps
Hydramax
Hydramax Accessories
X-Pander

Accessories

11-14

Citizen Accessories
Bar Chamfer Tool / Bar Loader Collets

Discover Winit Tool, the right partner, Who just like you, is in it to Winit!



ECO-JET LOW COST LOCK- SCREW COOLANT NOZZLES



PART #	OD	EXTENSION LENGTH	PRICE PER PACK
ECO10750	10MM	.75"	\$24.00
ECO10125	10MM	1.25"	\$24.50
ECO10175	10MM	1.75"	\$25.00
ECO11750	11MM	.75"	\$25.00
ECO11125	11MM	1.25"	\$25.50
ECO10175	11MM	1.75"	\$26.00
ECO12750	12MM	.75"	\$26.50
ECO12125	12MM	1.25"	\$27.00
ECO12175	12MM	1.75"	\$27.50
ECO14750	14MM	.75"	\$28.00
ECO14125	14MM	1.25"	\$28.50
ECO14175	14MM	1.75"	\$29.00
ECO15750	15MM	.75 "	\$29.50
ECO15125	15MM	1.25"	\$30.00
ECO20750	20MM	.75"	\$32.50
ECO20125	20MM	.75"	\$32.50
ECO20175	20MM	1.75"	\$32.50
ECO38750	3/8"	.75"	\$24.00
ECO38750	3/8"	1.25"	\$24.50
ECO38750	3/8"	1.75"	\$25.00
ECO50750	1/2"	.75"	\$25.50
ECO50125	1/2"	1.25"	\$26.00
ECO50175	1/2"	1.75"	\$26.50
ECO63750	5/8"	.75"	\$27.00
ECO63125	5/8"	1.25"	\$27.50
ECO63175	5/8"	1.75"	\$28.00
ECO56750	9/16"	.75"	\$28.50
ECO56125	9/16"	1.25"	\$29.00
ECO56175	9/16"	1.75"	\$29.50

**ADJUSTABLE COOLANT NOZZLES
FOR SCREW-LOCK STYLE TOOL
HOLDERS**

**LOW COST FIXED NOZZLE LENGTH
MADE FROM DURABLE ACETAL
PLASTIC CAPABLE OF STANDING
UP TO A RIGOROUS MACHINING
ENVIRONMENT.**

RATED TO 300PSI

SIZES TO FIT MOST CONFIGURATIONS

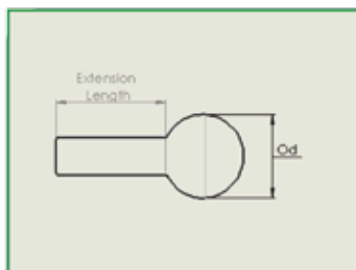



FLUSH-JET PRESS IN COOLANT NOZZLES WITH TAPPED HOLE

PART NO.	PRESS IN HOLE SIZE	ID	THREAD SIZE	5 PK
FJ12PPKS-750	12MM	TAPPED	M5X.8	\$41.00
FJ12PPKS-125	12MM	TAPPED	M5X.8	\$41.00
FJ12PPKS-175	12MM	TAPPED	M5X.8	\$41.50
FJ13PPKS-750	13MM	TAPPED	M5X.8	\$42.50
FJ13PPKS-125	13MM	TAPPED	M5X.8	\$42.50
FJ13PPKS-175	13MM	TAPPED	M5X.8	\$42.50
FJ14BPKS-750	14MM	TAPPED	M5X.8	\$46.00
FJ14BPKS-125	14MM	TAPPED	M5X.8	\$46.00
FJ14BPKS-175	14MM	TAPPED	M5X.8	\$46.00
FJ15BPKS-750	15MM	TAPPED	M5X.8	\$46.00
FJ15BPKS-125	15MM	TAPPED	M5X.8	\$46.00
FJ15BPKS-175	15MM	TAPPED	M5X.8	\$46.00
FJ16BPKS-750	16MM	TAPPED	M5X.8	\$48.00
FJ16BPKS-125	16MM	TAPPED	M5X.8	\$48.00
FJ16BPKS-175	16MM	TAPPED	M5X.8	\$48.00
FJ438BPKS-750	7/16"	TAPPED	M5X.8	\$41.00
FJ438BPKS-125	7/16"	TAPPED	M5X.8	\$41.00
FJ438BPKS-175	7/16"	TAPPED	M5X.8	\$41.00
FJ500BPKS-750	1/2"	TAPPED	M5X.8	\$42.50
FJ500BPKS-125	1/2"	TAPPED	M5X.8	\$42.50
FJ500BPKS-175	1/2"	TAPPED	M5X.8	\$42.50

EASY INSTALLATION SIMPLY DRILL, REAM AND PRESS IN COOLANT NOZZLE

IDEAL FOR CUSTOM TOOL HOLDERS OR ADDING EXTRA COOLANT PORTS.

COOLANT BALLS ARE TAPPED FOR USE WITH AN EXTENSION TUBE OR PLUG WITH A SET SCREW

EACH SET OF FLUSH-JETS COME WITH A SET OF RIGID EXTENSION TUBES, PLEASE SPECIFY LENGTH WHEN ORDERING

**MAX OPERATING PRESSURE-150PSI
MAX OPERATING TEMPERATURE-160F**

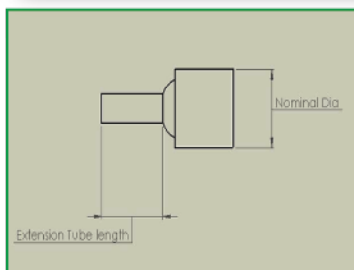

WINIT TOOL'S MONKEY KNUCKLES PROVIDE AN ADDITIONAL 35 DEGREES OF MOTION WHEN A STANDARD NOZZLE WON'T QUITE WORK.

PRESS IN MONKEY KNUCKLES

PART No.	OD	THREAD SIZE	5 PK
MK-10MMPPKS-750	10MM	M5X.8	\$59.15
MK-10MMPKS-125	10MM	M5X.8	\$59.15
MK-10MMPKS-175	10MM	M5X.8	\$59.15
MK-11MMPKS-750	11MM	M5X.8	\$60.55
MK-11MMPKS-125	11MM	M5X.8	\$60.55
MK-11MMPKS-175	11MM	M5X.8	\$60.55
MK-12MMPKS-750	12MM	M5X.8	\$63.12
MK-12MMPKS-125	12MM	M5X.8	\$63.12
MK-12MMPKS-175	12MM	M5X.8	\$63.12
MK-13MMPKS-750	13MM	M5X.8	\$65.24
MK-13MMPKS-125	13MM	M5X.8	\$65.24
MK-13MMPKS-175	13MM	M5X.8	\$65.24
MK-14MMPKS-750	14MM	M5X.8	\$67.76
MK-14MMPKS-125	14MM	M5X.8	\$67.76
MK-14MMPKS-175	14MM	M5X.8	\$67.76
MK-15MMPKS-750	15MM	M5X.8	\$69.74
MK-15MMPKS-125	15MM	M5X.8	\$69.74
MK-15MMPKS-175	15MM	M5X.8	\$69.74
MK-16MMPKS-750	16MM	M5X.8	\$70.45
MK-16MMPKS-125	16MM	M5X.8	\$70.45
MK-16MMPKS-175	16MM	M5X.8	\$70.45
MK-437BPKS-750	4375"	M5X.8	\$67.87
MK-1437BPKS-125	4375"	M5X.8	\$67.87
MK-437BPKS-175	4375"	M5X.8	\$67.87
MK-500BPKS-750	500"	M5X.8	\$68.67
MK-500BPKS-125	500"	M5X.8	\$68.67
MK-500BPKS-175	500"	M5X.8	\$68.67

PRESS IN DOUBLE MONKEY KNUCKLES

PART No.	OD	THREAD SIZE	5 PK
MKD-10MMPPKS-750	10MM	M5X.8	\$69.75
MKD-10MMPKS-125	10MM	M5X.8	\$69.75
MKD-10MMPKS-175	10MM	M5X.8	\$69.75
MKD-11MMPKS-750	11MM	M5X.8	\$70.50
MKD-11MMPKS-125	11MM	M5X.8	\$70.50
MKD-11MMPKS-175	11MM	M5X.8	\$70.50
MKD-12MMPKS-750	12MM	M5X.8	\$72.45
MKD-12MMPKS-125	12MM	M5X.8	\$72.45
MKD-12MMPKS-175	12MM	M5X.8	\$72.45
MKD-13MMPKS-750	13MM	M5X.8	\$73.45
MKD-13MMPKS-125	13MM	M5X.8	\$73.45
MKD-13MMPKS-175	13MM	M5X.8	\$73.45
MKD-14MMPKS-750	14MM	M5X.8	\$73.45
MKD-14MMPKS-125	14MM	M5X.8	\$73.45
MKD-14MMPKS-175	14MM	M5X.8	\$73.45
MKD-15MMPKS-750	15MM	M5X.8	\$73.45
MKD-15MMPKS-125	15MM	M5X.8	\$73.45
MKD-15MMPKS-175	15MM	M5X.8	\$73.45
MKD-16MMPKS-750	16MM	M5X.8	\$73.45
MKD-16MMPKS-125	16MM	M5X.8	\$73.45
MKD-16MMPKS-175	16MM	M5X.8	\$73.45
MKD-437BPKS-750	4375"	M5X.8	\$72.45
MKD-1437BPKS-125	4375"	M5X.8	\$72.45
MKD-437BPKS-175	4375"	M5X.8	\$72.45
MKD-500BPKS-750	500"	M5X.8	\$72.95
MKD-500BPKS-125	500"	M5X.8	\$72.95
MKD-500BPKS-175	500"	M5X.8	\$72.95



THE CLOSEST PORT IN THIS APPLICATION IS UTILIZING A FLUSH-JET WITH AN OPTIONAL MONKEY KNUCKLE INSTALLED.

THE REAR PORT ON THIS APPLICATION IS FLUSH-JET PLUGGED WITH A SOCKET HEAD CAP SCREW.

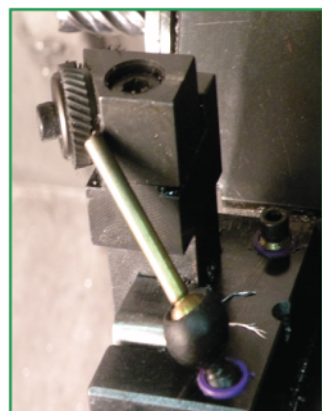

THREADED MONKEY KNUCKLES

PART No.	OD	THREAD SIZE	5 PK
MK-125NPTPKS	1/8IN NPT/BS	M5X.8	\$62.50
MK-250NPTPKS	1/4IN NPT/BS	M5X.8	\$66.50
MK-375NPTPKS	3/8IN NPT/BS	M5X.8	\$71.37
MK-1015MMPKS	M10x1.50	M5X.8	\$67.65
MK-1012MMPKS	M10x1.25	M5X.8	\$67.65
MK-1217MMPKS	M12x1.75	M5X.8	\$67.65

DOUBLE THREADED MONKEY KNUCKLES

PART No.	OD	THREAD SIZE	5 PK
MKD-125NPTPKS	1/8IN NPT/BS	M5X.8	\$64.50
MKD-250NPTPKS	1/4IN NPT/BS	M5X.8	\$68.50
MKD-375NPTPKS	3/8IN NPT/BS	M5X.8	\$73.37
MKD-1015MMPKS	M10x1.50	M5X.8	\$69.65
MKD-1012MMPKS	M10x1.25	M5X.8	\$69.65
MKD-1217MMPKS	M12x1.75	M5X.8	\$69.65

**MAX OPERATING PRESSURE-150PSI
MAX OPERATING TEMPERATURE-160F**





THREAD-JET SCREW IN COOLANT NOZZLES

THREAD-JET SCREW IN NOZZLES

PART NO.	PRESS IN HOLE SIZE	ID	THREAD SIZE	5 PK
TJ125NPTPKS-750	1/8" NPT/BST	TAPPED	M5X.8	\$38.59
TJ125NPTPKS-125	1/8" NPT/BST	TAPPED	M5X.8	\$38.59
TJ125NPTPKS-175	1/8" NPT/BST	TAPPED	M5X.8	\$38.59
TJ250NPTPKS-750	1/4" NPT/BST	TAPPED	M5X.8	\$38.96
TJ250NPTPKS-125	1/4" NPT/BST	TAPPED	M5X.8	\$38.96
TJ250NPTPKS-175	1/4" NPT/BST	TAPPED	M5X.8	\$38.96
TJ375NPTPKS-750	3/8" NPT/BST	TAPPED	M5X.8	\$40.27
TJ375NPTPKS-125	3/8" NPT/BST	TAPPED	M5X.8	\$40.27
TJ375NPTPKS-175	3/8" NPT/BST	TAPPED	M5X.8	\$40.27
TJ10X125PKS-750	M10x1.25	TAPPED	M5X.8	\$44.92
TJ10X125PKS-125	M10x1.25	TAPPED	M5X.8	\$44.92
TJ10X125PKS-175	M10x1.25	TAPPED	M5X.8	\$44.92
TJ12X125PKS-750	M12x1.25	TAPPED	M5X.8	\$51.97
TJ12X125PKS-125	M12x1.25	TAPPED	M5X.8	\$51.97
TJ12X125PKS-175	M12x1.25	TAPPED	M5X.8	\$51.97

EASY THREAD IN INSTALLATION, SCREWS INTO A THREADED PORT. LARGE RANGE OF MOTION, 35 DEGREES OF ADJUSTMENT OFF CENTERLINE

AVAILABLE FOR MOST MACHINES.

COOLANT BALLS ARE TAPPED FOR USE WITH AN EXTENSION TUBE OR PLUG WITH A SET SCREW

EACH SET OF FLUSH-JETS COME WITH A RIGID EXTENSION TUBES, PLEASE SPECIFY LENGTH WHEN ORDERING

**MAX OPERATING PRESSURE-150PSI
MAX OPERATING TEMPERATURE-160F**

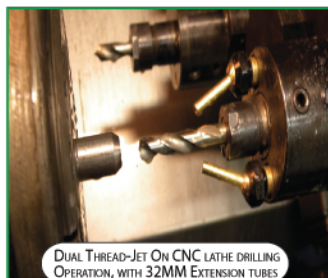

DUAL THREAD-JET ON CNC LATHE DRILLING OPERATION, WITH 32MM EXTENSION TUBES



THREAD JET SHOWN ON VDI LIVE TOOL WITH 44MM EXTENSION TUBE.

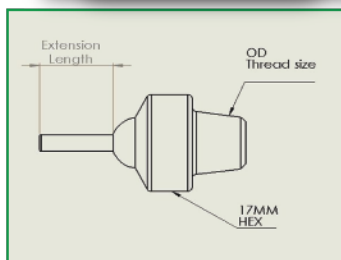

SCREW-LOCK BRASS COOLANT NOZZLES BALLS



SCREW-LOCK BRASS BALLS

PART #	OD THD SIZE	ID	ID THREAD SIZE	5 Pk
BB-10M5PKS-750	10MM	TAPPED	M5X.8	\$25.03
BB-10M5PKS-125	10MM	TAPPED	M5X.8	\$25.03
BB-10M5PKS-175	10MM	TAPPED	M5X.8	\$25.03
BB-12M5PKS-750	12MM	TAPPED	M5X.8	\$34.20
BB-12M5PKS-125	12MM	TAPPED	M5X.8	\$34.20
BB-12M5PKS-175	12MM	TAPPED	M5X.8	\$34.20
BB-14M5PKS-750	14MM	TAPPED	M5X.8	\$34.20
BB-14M5PKS-125	14MM	TAPPED	M5X.8	\$34.20
BB-14M5PKS-175	14MM	TAPPED	M5X.8	\$34.20
BB-15M5PKS-750	15MM	TAPPED	M5X.8	\$31.05
BB-15M5PKS-125	15MM	TAPPED	M5X.8	\$31.05
BB-15M5PKS-175	15MM	TAPPED	M5X.8	\$31.05
BB-20M5PKS-750	20MM	TAPPED	M5X.8	\$36.67
BB-20M5PKS-125	20MM	TAPPED	M5X.8	\$36.67
BB-20M5PKS-175	20MM	TAPPED	M5X.8	\$36.67
BB-22M5PKS-750	22MM	TAPPED	M5X.8	\$44.79
BB-22M5PKS-125	22MM	TAPPED	M5X.8	\$44.79
BB-22M5PKS-175	22MM	TAPPED	M5X.8	\$44.79
BB-1/2M5PKS-750	1/2"	TAPPED	M5X.8	\$36.67
BB-1/2M5PKS-125	1/2"	TAPPED	M5X.8	\$36.67
BB-1/2M5PKS-175	1/2"	TAPPED	M5X.8	\$36.67
BB-5/8M5PKS-750	5/8"	TAPPED	M5X.8	\$38.99
BB-5/8M5PKS-125	5/8"	TAPPED	M5X.8	\$38.99
BB-5/8M5PKS-175	5/8"	TAPPED	M5X.8	\$38.99

EXTENSION TUBES

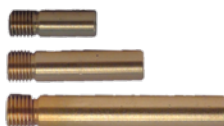

AVAILABLE IN THREE LENGTHS
20MM / 44MM

EXTENSION TUBES FIT
ALL BRASS BALLS

COOLANT BALLS ARE TAPPED FOR
USE WITH AN EXTENSION TUBE OR
PLUG WITH A SET SCREW

EACH SET OF COOLANT BALLS COME
WITH AN EXTENSION TUBES, PLEASE
SPECIFY LENGTH WHEN ORDERING

THE LEFT PORT ON THIS LIVE
TOOL UTILIZES A **12MM BRASS**
BALL WITH A **20MM RIGID**
EXTENSION TUBE

THE RIGHT PORT UTILIZES A **12MM**
COPPER COOLANT NOZZLE

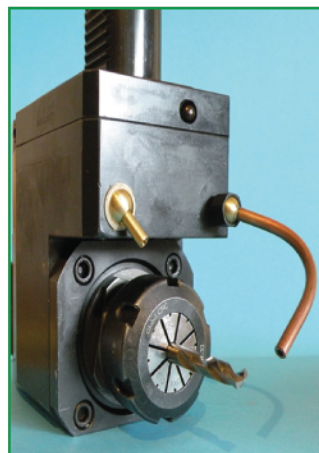
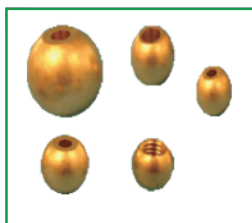



COPPER COOLANT PRODUCT

BRASS BALLS WITH BRAZED COPPER LINE

PART #	OD THREAD SIZE	EXTENSION LENGTH	5 Pk
BC10MMPKS	10MM	76MM	\$49.25
BC11MMPKS	11MM	76MM	\$49.25
BC12MMPKS	12MM	101MM	\$49.25
BC13MMPKS	13MM	76MM	\$50.00
BC14MMPKS	14MM	76MM	\$50.00
BC15MMPKS	15	76MM	\$50.00
BC18MMPKS	18	76MM	\$55.00
BC50MMPKS	1/2"	3IN	\$50.00
BC62MMPKS	5/8"	3IN	\$52.00

BENDABLE COPPER LINE HAS THE RIGIDITY FOR 500PSI

LIMITLESS ROUTING POSSIBILITIES

AIMING THE NOZZLE IS EASY WITH THE MONKEY JET NOZZLE

MONKEY JET

PART #	OD THREAD SIZE	EXTENSION LENGTH	5 Pk
MJ10MMPKS	10MM	76MM	\$72.15
MJ10MMPKS	11MM	76MM	\$73.15
MJ10MMPKS	12MM	101MM	\$74.15
MJ10MMPKS	13MM	76MM	\$75.15
MJ10MMPKS	14MM	76MM	\$76.15
MJ10MMPKS	15	76MM	\$77.15
MJ10MMPKS	18	76MM	\$78.15
MJ10MMPKS	1/2"	3IN	\$74.15
MJ10MMPKS	5/8"	3IN	\$75.45



AVAILABLE WITH THREADED AND SCREW LOCK BALLS.



MONKEY JET SHOWN IN A FACE GROOVING APPLICATION



BED CLAMPS FOR CNC VISES AND FIXTURE PLATES



BED CLAMPS

PART #	FOR USE WITH	# OF CLAMPS IN KIT	KIT PRICE
BEDC-3600V	3600V KURT	4 PCS	\$55.73
BEDC-D688	D688 KURT	4 PCS	\$55.75
DBEDC-D688	D688 KURT	4 PCS	\$87.95



WINIT TOOLS BED CLAMPS ARE AN IDEAL SOLUTION FOR CLAMPING VICES AND FIXTURE PLATES TO YOUR MACHINING CENTERS TABLE. THEY ARE SUITED EQUALLY WELL FOR BOTH VERTICAL, HORIZONTAL AND OTHER APPLICATIONS. OUR CLAMPS COVER THE MOUNTING BOLT WITH A SEALED REMOVABLE CAP. THIS HELPS REDUCE WEAR AND TEAR ON MOUNTING BOLTS WHICH AIDS IN REMOVAL OF WORK HOLDING DEVICES. A GREAT ALTERNATIVE TO OTHER BULKY CLAMPING SYSTEMS SUCH AS TOE CLAMPS.



BED CLAMP SECURELY HOLDING VISE IN VERTICAL MACHINING CENTER

- **CAP DESIGN PREVENTS CHIPS AND SWARF FROM ACCUMULATING IN SOCKET HEAD CAP SCREW.**
- **CLAMPS ARE HARDENED AND COATED FOR A LONG SERVICE LIFE.**
- **AVAILABLE FOR MOST VISES**





COPPER COOLANT

PART #	OD THREAD SIZE	ID	ID THREAD SIZE	EACH PRICE
BB-10M8	10MM	TAPPED	M5X.8	\$00.00
BB-10M8	12MM	TAPPED	M5X.8	\$00.00
BB-10M8	14MM	TAPPED	M5X.8	\$00.00
BB-10M8	15MM	TAPPED	M5X.8	\$00.00
BB-10M8	20MM	TAPPED	M5X.8	\$00.00
BB-10M8	22MM	TAPPED	M5X.8	\$00.00
BB-10M8	1/2"	TAPPED	M5X.8	\$00.00
BB-10M8	5/8"	TAPPED	M5X.8	\$00.00



HYDRA-10ST HOLDING 10 PLASTIC PARTS



HYDRA-5ST HOLDING CYLINDRICAL PARTS FOR SECOND OPERATION



HYDRA-6ST WITH CUSTOM CONTACT PADS

THE HYDRAMAX WORKHOLDING SYSTEM IS DESIGNED TO ALLOW MULTIPLE PARTS, WITH VARIATIONS IN SIZE TO BE SECURED IN A KURT VISE SIMULTANEOUSLY.

PROBLEMS USUALLY ASSOCIATED WITH ATTEMPTING TO HOLD MULTIPLE PARTS IN ONE VISE ARE VIRTUALLY ELIMINATED.

SAVE TIME AND MONEY WITHOUT THE HASSLES OF BROKEN CUTTERS, SCRAPED PARTS, OR DAMAGED FIXTURES.

ALSO FRAGILE PARTS CAN BE HELD SECURELY, WITHOUT CRUSHING PRESSURE.



THE SYSTEM INCLUDES TWO JAWS BOTH EQUIPPED WITH OUR FASTBACK WASHER MOUNTING PLATES.

THE SOLID JAW IS REPLACED BY A SIMPLE MACHINABLE ALUMINUM SOFT JAW, WHILE THE MOVEABLE JAW IS REPLACED BY THE HYDRAMAX JAW.

THE HYDRAMAX JAW INCORPORATES SEVERAL INDEPENDENTLY ACTING CLAMPING PISTONS. THESE PISTONS COMPENSATE FOR VARIATIONS IN THE PARTS BEING HELD.

THE SELF-CONTAINED HYDRAULIC CHAMBER WITHIN THE JAW EQUALIZES THE PRESSURE OF THE INDIVIDUAL PISTONS, ALLOWING THE JAW TO ADAPT TO THE PARTS BEING HELD FOR MACHINING.

MULTIPLE SYSTEMS ARE AVAILABLE WITH VARIATIONS IN THE SIZE AND NUMBER OF HYDRAULIC PISTONS WITHIN THE SELF-CONTAINED JAW UNIT.



FASTBACK INTERCHANGE SYSTEM/BRIDGES

PART #	DESCRIPTION	EACH PRICE
HYDRA 5-4	4 PISTON JAW (4 INCH)	\$412.50
HYDRA 5-4	5 PISTON JAW KURT (4 INCH)	\$412.50
HYDRA - 10ST	10 PISTON JAW (KURT 6 INCH)	\$659.45
HYDRA-4ST	4 PISTON JAW (KURT 6 INCH)	\$493.62
HYDRA-5ST	5 PISTON JAW (KURT 6 INCH)	\$510.40
HYDRA-6ST	6 PISTON JAW (KURT 6 INCH)	\$527.89
HYDRA-7ST	7 PISTON JAW (KURT 6 INCH)	\$534.82
HYDRA-10ST	10 PISTON JAW (KURT 6 INCH)	\$659.45
HYDRA-5-8	5 PISTON JAW (KURT 8 INCH)	\$550.00
HYDRA-8-8	8 PISTON JAW (KURT 8 INCH)	\$584.00
HYDRA-6ST	MACHINIBLE BRIDGES	\$87.80
HYDRA-10STB	5PCS BRIDGES FOR 10ST	\$68.50
HYDRA-10B	10ST BRIDGES	\$59.00

CONTACT PADS

PART #	DESCRIPTION	EACH PRICE
HYDRA-5BP	1" BRASS CONTACT PADS (SET OF 5)	\$30.25
HYDRA-10PP	.5" PLASTIC CONTACT PADS (SET OF 10)	\$30.25
HYDRA-6PP	.75" PLASTIC CONTACT PADS (SET OF 6)	\$30.25
HYDRA-7PP	.75" PLASTIC CONTACT PADS (SET OF 7)	\$30.25
HYDRA-8BP	.75 BRASS CONTACT PAD (8PCS)	\$63.00
HYDRA-7BP	.75 BRASS CONTACT PAD (7PCS)	\$63.00

CONTACT PADS

BRASS AND PLASTIC CONTACT PADS ARE AVAILABLE FOR ALL HYDRAMAX WORK HOLDING SYSTEMS. THE CONTACT PADS PREVENT THE HARD PISTON IN THE HYDRAMAX FROM CONTACTING AND DAMAGING YOUR PARTS.



BRIDGES

A SOFT JAW THAT LINKS TWO ADJACENT PISTONS. THE SOFT JAW CAN BE MACHINED UP TO 5/16 DEEP ON BOTH SIDES. THE ADDED BENEFIT OF THE MACHINABLE BRIDGES IS THAT IRREGULAR PARTS CAN NOW EASILY BE HELD WITH THE HYDRAMAX WORKHOLDING SYSTEM. THE BRIDGES ARE EASILY SECURED TO THE HYDRAMAX PISTONS AND CAN BE MACHINED IN PLACE LIKE A STANDARD SOFT JAW.

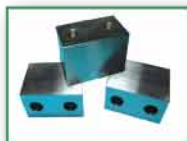

FASTBACK INTERCHANGE SYSTEM

THE JAWS CHANGE EASILY WITHOUT OPENING THE VISE OR FASTENING BOLTS MORE THAN A SINGLE TURN. A PAIR OF VISE JAWS CHANGES OUT IN UNDER A MINUTE WITH THE VISE OPEN OR CLOSED. USING A SUPPLIED 6-INCH HEX WRENCH TO REACH THROUGH THE VISE BODY, THE FASTBACK BOLT IS LOOSENED, OR TIGHTENED FROM THE REVERSE SIDES OF THE VISE. THE SYSTEM SAVES VALUABLE SET-UP TIME ON RETURN JOBS BECAUSE IT ALLOWS THE JAWS TO BE FASTENED WHILE THE PARTS ARE ALREADY HELD IN THE VISE.





X-PANDER SYSTEMS

HYDRAMAX

A Winit Tool Company



THE X-PANDER WORKS WITH THE HYDRAMAX WORKHOLDING SYSTEM TO HOLD SMALL PARTS ON THEIR ID.



THE X-PANDER SYSTEM DRAMATICALLY INCREASES PRODUCTION OF SMALL INTERNALLY HELD PARTS , ON MANUAL OR CNC MILLING MACHINES. THE SELF CONTAINED, MODULAR SYSTEM HOLDS 5 PARTS AT A TIME ON THE ID OF EACH PART.



THE VISE IS TIGHTENED AND THE X-PANDER IS MACHINED TO THE SIZE OF YOUR PARTS.



THE SOLID JAW OF THE MILLING MACHINE VISE IS REPLACED BY THE X-PANDER JAW THAT IS MACHINED IN PLACE TO HOLD MULTIPLE PARTS. THE SLIDING JAW IS REPLACED WITH THE HYDRAMAX 5ST WHICH USES 5 INDEPENDENTLY ACTING PISTONS JOINED TOGETHER BY A COMMON FLUID FILLED CHANNEL.



THE VISE IS LOOSENED AND THE LOCKING SET SCREWS ARE RELEASED.



THE X-PANDER SYSTEM WORKS TOGETHER WITH THE HYDRAMAX WORKHOLDING JAW TO COMPENSATE FOR ANY VARIATION IN THE SIZE OF THE INDIVIDUAL PARTS. THIS ALLOWS MULTI-PART MACHINING WITHOUT BROKEN CUTTERS, SCRAP PARTS, OR DAMAGED FIXTURES DUE TO ONE OR MORE PARTS NOT BEING HELD SECURELY.

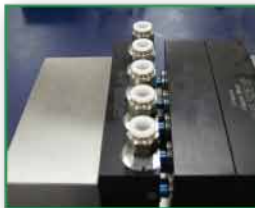

THE PARTS ARE LOADED ONTO THE X-PANDER AND THE VISE IS TIGHTENED. YOUR PARTS ARE READY TO BE MACHINED



THE PATENTED SYSTEM IS FAST AND EASY TO USE SINCE IT HAS NO EXTERNAL HYDRAULIC LINES AND IS TOTALLY SELF CONTAINED

SECOND OPERATION SUCH AS SLOTTING AND DRILLING ARE HANDLED QUICKLY AND EFFICIENTLY ,SINCE FIVE PARTS ARE HELD FOR EACH MACHINING CYCLE.



CITIZEN SCREW MACHINES ACCESSORIES



KNOCK-OUT JIGS

PART #	ID	EACH PRICE
CITK-M8	CITIZEN KNOCK-OUT JIG	\$85.95

KNOCK-OUT JIGS

WINIT TOOLS KNOCK OUT JIG FOR **CITIZEN MACHINES** WITH A **M8** EJECTOR ROD. THIS DESIGN IS A SIGNIFICANT IMPROVEMENT OVER ITS **OEM** COUNTER PART. **COOLANT PORTS** ARE LOCATED AT **90** DEGREES TO CENTERLINE.

THE LOCATION AND ORIENTATION OF THE COOLANT PORTS EFFECTIVELY CLEAR CHIPS AND DEBRIS FROM THE COUNTER SPINDLE. THE KIT IS MANUFACTURED FROM **300** SERIES STAINLESS STEEL TO ENSURE A LONG SERVICE LIFE.

COLLET FINGERS

PART #	ID	EACH PRICE
CITCF-20	CITIZEN COLLET FINGER REPLACEMENT	\$475.00

COLLET FINGERS

WINIT TOOLS REPLACEMENT COLLET CLOSER FEED FINGERS FOR A **CITIZEN L20 /A20**. THESE ARE MANUFACTURED TO THE **OEM** SPECIFICATION TO ENSURE THE LONGEST POSSIBLE SERVICE LIFE AND THE RELIABILITY YOU'VE COME TO COUNT ON FROM YOUR **CITIZEN**. THIS IS A DIRECT REPLACEMENT FOR YOUR WORN OUT COLLET CLOSER FINGERS, IN STOCK AND READY TO SHIP.

EXTENDED HOLDER

WINIT TOOLS EXTENDED HOLDER FOR **CITIZEN MACHINES**. THIS HOLDER ATTACHES TO THE DOG LEG AND PROVIDES AN ADDITIONAL TWO LOCATIONS FOR ID TOOLING BOTH FRONT AND BACK. GIVES YOU THE ABILITY TO HOLD A TOOL THAT IS **1.5IN** LONGER THAN THE STANDARD DOG LEG. WILL ACCEPT **1IN** TOOLING WITH **30MM** HOLE SPACING.





BAR CHAMFER TOOLS & LOADER COLLETS

BAR CHAMFER TOOL

THE BAR CHAMFER TOOL REDUCES THE LABOR AND COST ASSOCIATED WITH TRADITIONAL BAR CHAMFER MACHINES, INCLUDING SETUP AND TEAR DOWN. THE TOOL CAN BE POWERED BY A HAND DRILL TO EFFECTIVELY CUT A 45-DEGREE CHAMFER ON LIGHT METALS AND PLASTICS. DESIGNED AS A FLEXIBLE LOW COST ALTERNATIVE TO FIXED CHAMFER MACHINES.

PART #	OD THREAD SIZE	EACH PRICE
BRCT10	1"	\$185.00
BRCT75	3/4"	\$135.00
BRCT50	1/2"	\$115.00
BRCT25	1/4"	\$95.00
BRCT12	1/8"	\$75.00
BRCT15	1 1/2"	\$229.50
BRCT20	2"	\$382.84



BAR LOADER COLLETS

D-STYLE BAR LOADER COLLET FOR ANY LOADER USING THIS STYLE OF COLLET SOME OF THE BAR LOADER MANUFACTURES USING A **D-STYLE COLLETS** ARE EDGE TECHNOLOGY , LNS, FMB AND ROBOBAR. **WINIT TOOL MANUFACTURES ALL COLLETS FROM A HIGH QUALITY ALLOY STEEL IN THE PRE HARD STATE TO ENSURE CONSISTENT RESULTS AND A LONG SERVICE LIFE.** UNLIKE OUR COMPETITOR **WINIT TOOL PRODUCES ALL OUR LOADER COLLETS TO THE SAME GAGE LENGTH** SO BAR LOADER ADJUSTMENT DURING CHANGE OVER CAN BE KEPT TO A MINIMUM.

PART #	OD THREAD SIZE	EACH PRICE
BLC-250	.25"	\$64.99
BLC-375	.375"	\$64.99
BLC-438	.4375"	\$64.99
BLC-500	.5"	\$64.99
BLC-506	.5625"	\$64.99
BLC-625	.625"	\$64.99
BLC-750	.750"	\$64.99



PRICES

ALL THE PRICES ARE IN US DOLLARS AND SUBJECT TO CHANGE WITHOUT NOTICE. UNLESS OTHERWISE STATED ALL QUOTATIONS WILL EXPIRE THIRTY DAYS FROM THE DATE OF ISSUE.

SHIPPING

ALL FREIGHT AND PACKAGING COST WILL BE PAID BY THE CUSTOMER AND SHOWN SEPARATELY ON THE INVOICE. SHIPMENTS WILL BE INSURED AT VALUE AND INCLUDE IN THE SHIPPING COST. A 15% SHIPPING FEE MAY BE ADDED AT THE DISCRETION OF WINIT TOOL LLC

CANCELLATIONS

CANCELLED ORDERS AND ITEMS RETURNED FOR CREDIT MAY INCURE A \$15.00 PROCESSING CHARGE OR UP TO A 20% CANCELLATION OR RESTOCKING FEE. SPECIAL ORDERS AND CUSTOMS CANNOT BE RETURNED

RETURNS

WE WILL REPLACE OR ACCEPT RETURN ITEMS THAT ARE NOT WHAT WAS ORDERED OR FOUND TO BE DEFECTIVE. CLAIMS MUST BE SUBMITTED WITHIN 30 DAYS AND WILL NOT BE ACCEPTED WITHOUT A RETURN AUTHORIZATION FORM. ITEMS MUST BE RETURNED IN NEW CONDITION AND PROPERLY PACKAGED. RETURNED ITEMS THAT ARE DAMAGED, USED OR ARE MISSING PARTS MAY BE REFUSED FOR RETURN OR SUBJECT TO REPAIR CHARGES AND RESTOCKING CHARGE. ANY CREDIT DUE WILL BE ISSUED AS MERCHANDISE CREDIT AND APPLIED TOWARDS FUTURE PURCHASES





HYDRAMAX

A **Winit** Tool Company



PH: 503.623.8094

www.winittool.com